



SJE Oil Spotter™ Auto System installation instructions

The SJE Oil Spotter™ Auto control and alarm system is designed to monitor and control oil/water environments and provides a convenient location for all wiring required for an indoor simplex pump application. The SJE Oil Spotter™ Auto employs a terminal block for one 120 VAC pump, a 120 VAC oil containment valve and a 120 VAC water drain valve. Another terminal block is for wiring the SJE Oil Spotter™ Auto probe, high water alarm float, and auxiliary alarm connection. The panel also includes a Auto/Hand pump switch and Water/Oil Drain selection switch (functions in HAND mode only).

In normal operation the pump will turn on and off as the water level activates the probes (5" (12.7 cm) pumping range). If the water level rises enough to activate the high water probe, a red indicator will illuminate and activate auxiliary contacts. If the oil level reaches the high oil float, a red indicator will illuminate and activate the auxiliary contacts, the pump energizes along with the valves to automatically remove contaminated water/oil into the appropriate holding vessel.

In Hand operation (spring loaded) the operator can manually pump out the water/oil from the pit. The valve selection switch allows the operator to choose if the valves are activated or not.

Common applications include elevator sump basins, transformer vaults, leachate well applications or garages.

The SJE Oil Spotter™ Auto control and alarm system helps satisfy the requirements of an ASME A17.1 compliant system.

SJE OIL SPOTTER™ AUTO FEATURES

- NEMA 1 rated for indoor use
- Water/Oil Drain switch (functions in Hand mode only)
- SJE Oil Spotter™ Auto Panel with LED indicators for:
 - High Water Indicator (red)
 - High Oil Indicator (red)
 - Pump Run Indicator (green)
 - Power Indicator (green)
- Oil Water Switch includes:
 - High Oil Float
 - High Water Probe
 - Start Probe
 - Stop Probe
 - Reference Probe
- Auto/Hand switch (spring loaded to Auto)
- Pump Disconnect Breaker
- Control fuse
- Entire system is UL and cUL Listed to meet and/or exceed industry safety standards.
- Five-year limited warranty.

PREVENTATIVE MAINTENANCE

- Inspect the probes, panel, and wiring every two weeks for possible damages that could impair the performance of the product. Replace the product immediately if any damage is found or suspected.
- Use only SJE-Rhombus® replacement parts.

SJE-RHOMBUS® FIVE-YEAR LIMITED WARRANTY

SJE-RHOMBUS® warrants to the original consumer that this product shall be free of manufacturing defects for five years after the date of consumer purchase. During that time period and subject to the conditions set forth below, **SJE-RHOMBUS®** will repair or replace, for the original consumer, any component which proves to be defective due to defective materials or workmanship of **SJE-RHOMBUS®**.

ELECTRICAL WIRING AND SERVICING OF THIS PRODUCT MUST BE PERFORMED BY A LICENSED ELECTRICIAN.

THIS WARRANTY DOES NOT APPLY: (A) to damage due to lightning or conditions beyond the control of **SJE-RHOMBUS®**; (B) to defects or malfunctions resulting from failure to properly install, operate or maintain the unit in accordance with printed instructions provided; (C) to failures resulting from abuse, misuse, accident, or negligence; (D) to units which are not installed in accordance with applicable local codes, ordinances, or accepted trade practices, and (E) to units repaired and/or modified without prior authorization from **SJE-RHOMBUS®**.

Some states do not allow limitations on how long an implied warranty lasts, so the above limitation may not apply to you. Some states do not allow the exclusion or limitation of incidental or consequential damages, so the above limitation or exclusion may not apply to you. This warranty gives you specific legal rights, and you may also have other rights which vary from state to state.

TO OBTAIN WARRANTY SERVICE: The consumer shall assume all responsibility and expense for removal, reinstallation, and freight. Any item to be repaired or replaced under this warranty must be returned to **SJE-RHOMBUS®**, or such place as designated by **SJE-RHOMBUS®**.

ANY IMPLIED WARRANTIES OF MERCHANTABILITY OR FITNESS ARE LIMITED TO THE DURATION OF THIS WRITTEN WARRANTY. SJE-RHOMBUS® SHALL NOT, IN ANY MANNER, BE LIABLE FOR ANY INCIDENTAL OR CONSEQUENTIAL DAMAGES AS A RESULT OF A BREACH OF THIS WRITTEN WARRANTY OR ANY IMPLIED WARRANTY.

⚠ WARNING**ELECTRICAL SHOCK HAZARD**

Disconnect power before installing or servicing this product. A qualified service person must install and service this product according to applicable electrical and plumbing codes.

⚠ WARNING**EXPLOSION OR FIRE HAZARD**

Do not use this product with flammable liquids. Do not install in hazardous locations as defined by National Electrical Code, ANSI/NFPA 70.

Failure to follow these precautions could result in serious injury or death. Replace product immediately if switch cable becomes damaged or severed. Keep these instructions with warranty after installation. This product must be installed in accordance with National Electric Code, ANSI/NFPA 70 so as to prevent moisture from entering or accumulating within boxes, conduit bodies, fittings, float housing, or cable.

For detailed specifications on this product, or for the complete line of SJE-Rhombus® panel, alarm, and switch products, visit our web site at www.sjrhombus.com.

INSTALLING THE SJE OIL SPOTTER™ AUTO SYSTEM CONTROL PANEL

1. Determine desired location to mount the SJE Oil Spotter™ Auto control panel (Figure A).
2. Attach the mounting flanges to the control panel enclosure. Mount panel at the desired location making sure the mounting location of the control panel is within 10 feet of the Oil Water Switch mounting location.
3. Hard wire all connections to terminal block(s) inside control panel. Apply 120 VAC power to the control panel only when ready for testing. Verify the green "power" light illuminates.
4. Make sure to test SJE Oil Spotter™ Auto System (see page 4).

Figure A

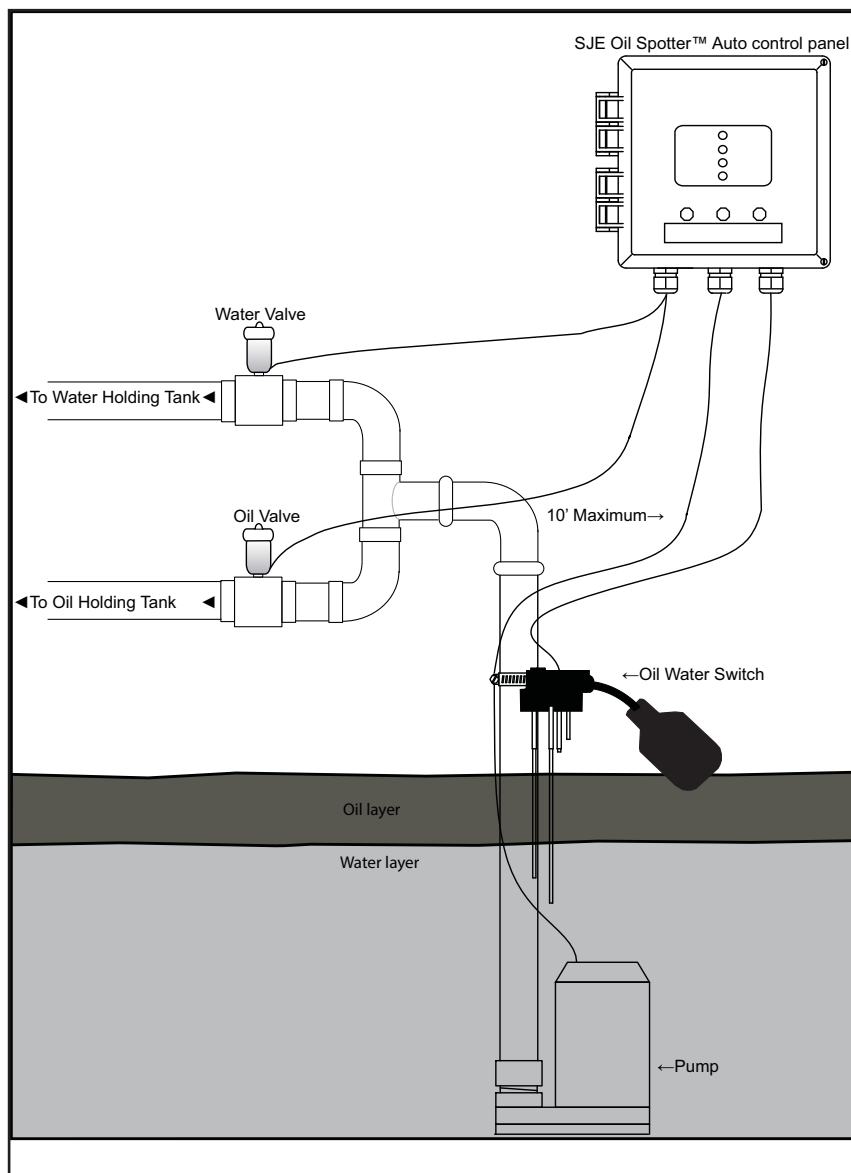

INSTALLING THE OIL WATER SWITCH

Caution: The Oil Water Switch cable needs to run in separate conduit from the pump and power lines.

1. Determine the proper position for the Oil Water Switch (**Figure B**).
2. Position the Oil Water Switch at the appropriate location on the pipe and secure the switch as shown (**Figure B**).
3. Tighten all hose clamps using a screw driver. Over-tightening may result in damage to the plastic parts.
Note: All hose clamp components are made of 18-8 stainless steel material. See your SJE-Rhombus® supplier for replacement parts.

Caution: Do not splice the Oil Water Switch cable. Doing so could cause the system to fail.

Figure B

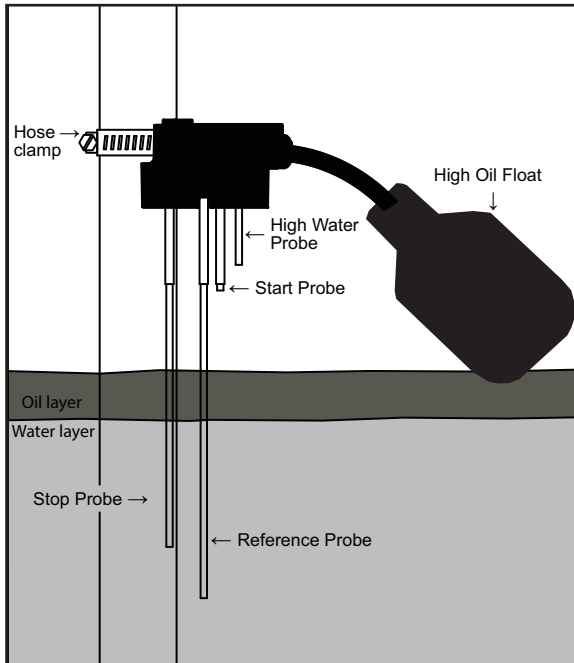

If using auxiliary contacts, connect wire to terminal block as shown in **Figure C**.

Figure C

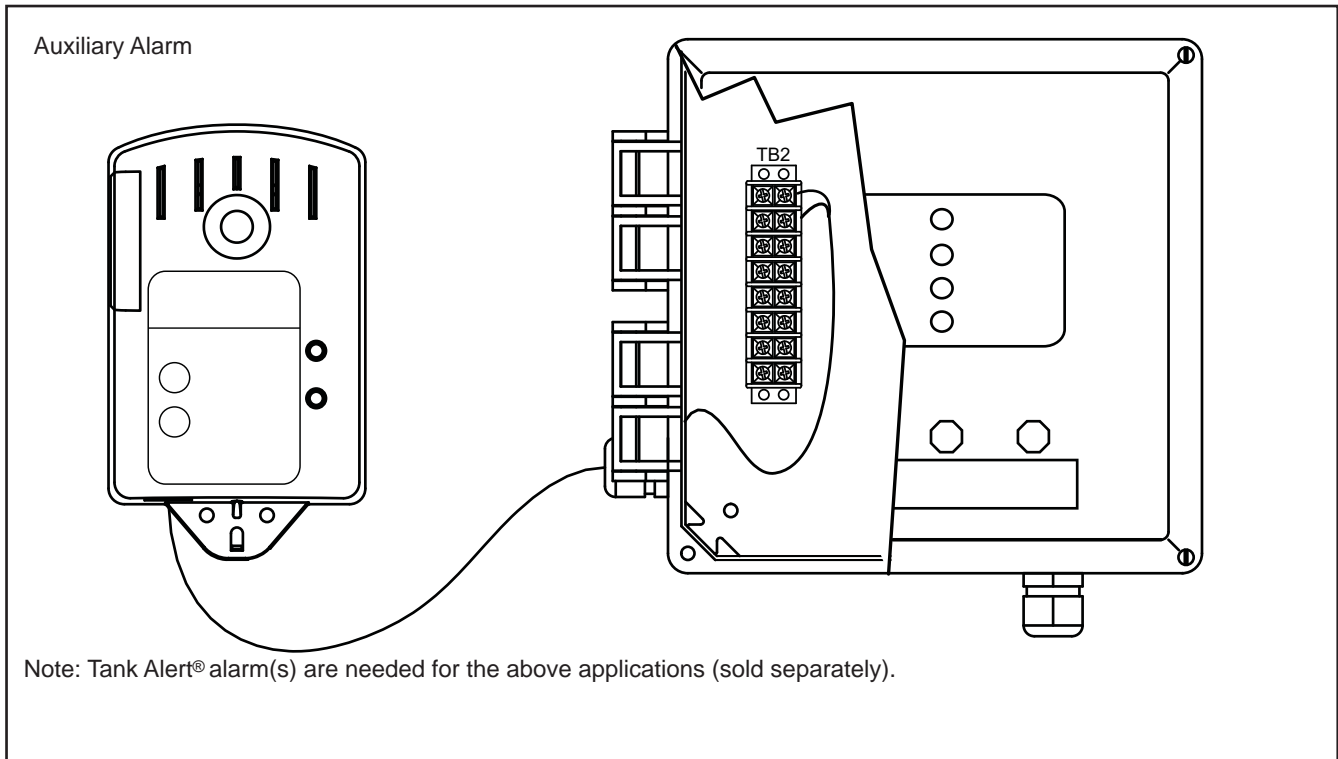

Note: Tank Alert® alarm(s) are needed for the above applications (sold separately).

